



**河北雄安盛蕴科技有限公司**  
HEBEI XIONGAN SHARE TECHNOLOGY CO., LTD.



中国·雄安



## About us

Hebei Xiongan Share Technology Co., Ltd. is located in Baoding China. Being a leading manufacturer, supplier and exporter in lifting and handling industry and construction machinery industry, we provide a widely variety of solutions for our customers' needs, whether for the standard materials or special designs. We promise offering the highest quality products and providing the best possible service and supports to our customers.

### Our Vision:

- Make handling easier!

### Our Mission:

- To know the real needs of customer,
- To provide the best solutions of customer,
- To create sustainable development for customer.

### Our Values:

- Customers are friends,
- Employees are family,
- Suppliers are brothers.

### Our Concept:

- Strictly Quality Control;
- Satisfied Customer Service;
- Full Range products.



# ABOUT US



Explosion-Proof  
Series Products

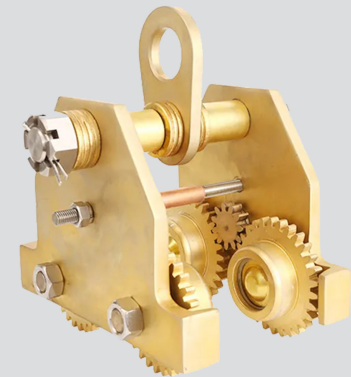





防爆信息 Explosion-proof information

区域等级 Regional level

易燃材料 Flammable materials	爆炸危险区域的分类 classification of the explosion danger area	设备组 equipment group	大气设备类别 Atmospheric equipment category	概率 probability
气体 & 蒸汽 Gas and steam	区域0 area0	II	1G	恒定, 长期或频繁 Constant, long-term or frequent
	区域1 area1	II	2G 或 1G 2G or 1G	偶然 By chance
	区域2 area2	II	3G 或 2G 或 1G 3G or 2G or 1G	不可能 impossibility
粉尘 dust	区域20 area20	II	1D	恒定 constant
	区域21 area21	II	2D 或 1D 2D or 1D	偶然 By chance
	区域22 area22	II	3D 或 2D 3D or 2D	不可能 impossibility

可部署温度等级 Can be deployed temperature level

操作材料配置 configuration	气体和蒸汽的列表 The list of gases and vapors						
	爆炸组II的 点火保护类型 d,i,n	气体和蒸汽 Gas and steam					
IIA IIB IIC	IIA	氨, 甲烷, 乙烷, 丙烷 Ammonia, Methane, Ethane, propane	乙醇, 环己烷, 正丁烷 Ethanol, Cyclohexane, n-butane	苯代燃气燃料, Benzene generation of jet fuel, 正己烷 n-hexane	乙醛 acetaldehyde		
	IIB	丙烯腈, 城市燃气 Acrylonitrile, City gas	乙烯, 环氧乙烷 ethylene, Epoxy ethane	乙二醇, 硫化氢 Ethylene glycol, Hydrogen sulfide	乙醚 ether		
	IIC	氢 hydrogen	乙炔 acetylene				二硫化碳 Carbon disulfide
温度等级, 分类的气体, 蒸汽和烟雾根据点火温度 Classification of gas, steam and smoke according to the ignition temperature							
T1 最高 450°C		T2 最高 300°C	T3 最高 200°C	T4 最高 135°C	T5 最高 100°C	T6 最高 85°C	
操作材料配置 The operating materials configuration							
----- > T1							
----- > T2							
----- > T3							
----- > T4							
----- > T5							
----- > T6							

HBSQ型防爆手拉葫芦

HBSQ type explosion proof chain hoist

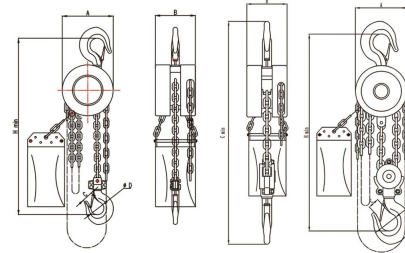

- 防爆手拉葫芦除可单独使用外, 还可同电动葫芦, 链条或电动小车装配在一起悬挂在建筑物的顶棚或起重机的梁上使用。
- 也可配合单轨小车, 实现左右行走提升重物的功能, 防爆手拉葫芦的安装, 拆卸都十分方便, 安全, 快捷。
- 防爆手拉葫芦以铝青铜, 铍青铜作为毛坯, 手拉葫芦外壳采用H62铜合金材料。
- 受力摩擦部位包括构成手拉葫芦的起重轮, 手链轮, 墙板, 挂钩, 齿轮轴轴采用铝青铜, 铍青铜合金材料。
- 产品安全可靠, 设计先进, 链条摩擦不会引发火花发生爆炸等不良反应。
- Explosion-proof hand chain block can be used alone, and also can be used with electric block, chain or electric trolley assembly together, hanging on the roof of buildings or the crane beam.
- Also with the monorail trolley, realizing the walking around when lifting a heavy weight function. The installation and disassembly of explosion-proof hand chain block is very convenient, safe and fast.
- Explosion-proof hand chain block with is produced with aluminum bronze. Beryllium bronze as a blank. By force of friction parts including forming hand chain block up heavy wheel, chain wheel, wall panels, hook, gear shaft is made of aluminum bronze, beryllium bronze alloy materials.
- The product is safe and reliable. The design is advanced. When lifting, the copper and iron do not spark. There fore, there is no explosion and other adverse reactions.

型号 Model	HBSQ0.5	HBSQ1	HBSQ2	HBSQ3	HBSQ5	HBSQ7.5	HBSQ10	HBSQ20
额定载荷 Capacity(t)	0.5	1	2	3	5	7.5	10	20
起重高度 Lifting height(m)	2.5	2.5	2.5	3	3	3	3	3
试验载荷 Test load(t)	0.75	1.5	3	4.5	7.5	11.2	12.5	25
链条行数 No. of load chain fall lines	1	1	2	2	2	3	4	8
尺寸 Dimensions(mm)	A	142	142	142	178	266	350	360
	B	130	130	130	150	170	170	170
	Hmin	300	326	440	600	650	880	900
	D	30	43	50	63	65	72	77
净重 Net weight(kg)	12	13	16	26	38	66	83	180



### HBSQ型防爆手拉葫芦

HBSQ type explosion-proof chain hoist

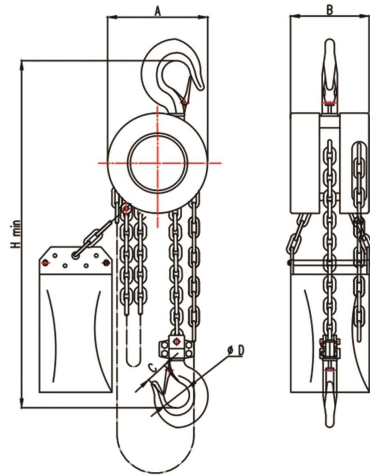

铍青铜  
Beryllium bronze

### HBSQ-F型防爆手拉葫芦(全封闭式)

HBSQ-F type explosion proof chain hoist(Totally enclosed)

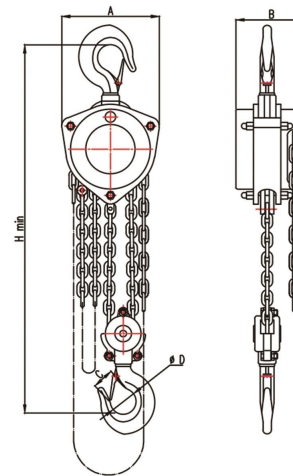

型号 Model	HBSQ0.5	HBSQ1	HBSQ2	HBSQ3	HBSQ5	HBSQ7.5	HBSQ10	HBSQ20
额定载荷 Capacity(t)	0.5	1	2	3	5	7.5	10	20
起重高度 Lifting height(m)	2.5	2.5	2.5	3	3	3	3	3
试验载荷 Test load(t)	0.75	1.5	3	4.5	7.5	11.2	12.5	25
链条行数 No. of load chain fall lines	1	1	2	2	2	3	4	8
尺寸 Dimensions(mm)	A	142	142	178	266	350	360	580
	B	130	130	130	150	170	170	170
	Hmin	300	326	440	600	650	880	900
	D	30	43	50	63	65	72	77
净重 Net weight(kg)	12	13	16	26	38	66	83	180

型号 Model	HBSQ-F0.5	HBSQ-F1	HBSQ-F2	HBSQ-F3	HBSQ-F5	HBSQ-F7.5	HBSQ-F10	HBSQ-F20
额定载荷 Capacity(t)	0.5	1	2	3	5	7.5	10	20
起重高度 Lifting height(m)	2.5	2.5	2.5	2.5	2.5	2.5	2.5	2.5
试验载荷 Test load(t)	0.75	1.5	3	4.5	7.5	11.2	12.5	25
链条行数 No. of load chain fall lines	1	1	2	2	2	3	4	8
尺寸 Dimensions(mm)	A	170	170	210	253	380	390	590
	B	130	130	130	150	168	186	186
	Hmin	380	400	500	630	670	880	900
	D	30	43	50	63	65	72	77
净重 Net weight(kg)	12	13	16	26	38	66	83	180



### HBSQ-Z型防爆手拉葫芦(低净空)

HBSQ - Z type explosion proof chain hoist(Low headroom)

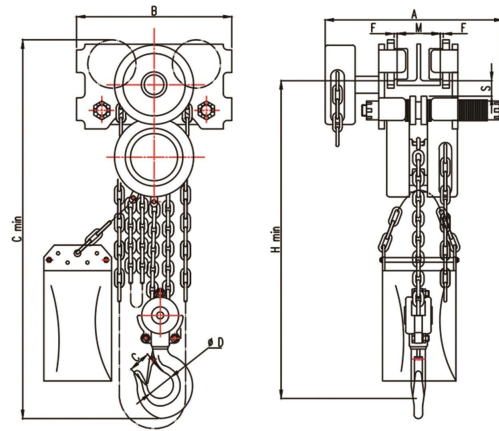

型号Model	HBSQ-Z 0.5	HBSQ-Z 1	HBSQ-Z 2	HBSQ-Z 3	HBSQ-Z 5	HBSQ-Z 7.5	HBSQ-Z 10	HBSQ-Z 20
额定载荷 Capacity(t)	0.5	1	2	3	5	7.5	10	20
起重高度 Lifting height(m)	2.5	2.5	2.5	2.5	2.5	2.5	2.5	2.5
试验载荷 Test load(t)	0.75	1.5	3	4.5	7.5	11.2	12.5	25
链条行数 No. of load chain fall lines	1	1	2	2	2	3	4	8
推荐使用工字钢 I-Beam width(m)	75-125	75-125	100-150	100-150	125-175	124-203	125-180	136-203
尺寸 Dimension(mm)	B	245	245	275	350	380	420	760
	Hmin	310	330	410	480	650	750	950
	D	30	43	50	63	65	72	106
净重 Net weight(kg)	25	26	35	50	70	112	130	290

### HBSQ-F型防爆手拉葫芦(低净空)

HBSQ-F type explosion proof chain hoist(Low headroom)

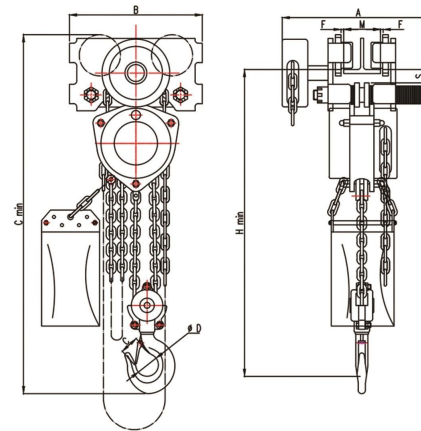

型号Model	HBSQ-F 0.5	HBSQ-F 1	HBSQ-F 2	HBSQ-F 3	HBSQ-F 5	HBSQ-F 7.5	HBSQ-F 10	HBSQ-F 20
额定载荷 Capacity(t)	0.5	1	2	3	5	7.5	10	20
起重高度 Lifting height(m)	2.5	2.5	2.5	2.5	2.5	2.5	2.5	2.5
试验载荷 Test load(t)	0.75	1.5	3	4.5	7.5	11.2	12.5	25
链条行数 No. of load chain fall lines	1	1	2	2	2	3	4	8
推荐使用工字钢 I-Beam width(m)	75-125	75-125	100-150	100-150	125-175	124-203	125-180	136-203
尺寸 Dimensions(mm)	B	245	245	275	350	380	420	760
	Hmin	390	404	470	510	670	750	950
	D	30	43	50	63	65	72	106
净重 Net weight(kg)	25	26	35	50	70	112	130	290





HBSH型防爆手扳葫芦

HBSH type explosion-proof lever hoist

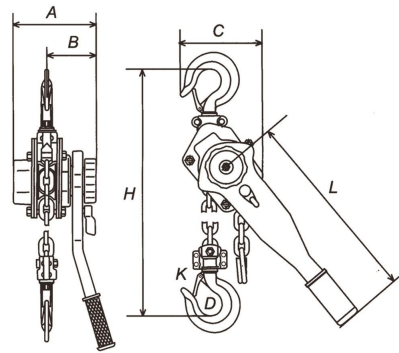

型号 Type	HBSH-0.75	HBSH-1.5	HBSH-3	HBSH-6	HBSH-9	
额定起重量 Rated lifting weight T	0.75	1.5	3	6	9	
标准起重高度 Standard lifting height(m)	1.5	1.5	1.5	1.5	1.5	
试验载荷 Testing load KN	11	22	37.5	75	135	
起重链条行数 Lifting chain lines	1	2	2	4	4	
满载时手扳力 Chain pull to lift full load N	140	220	240	260	360	
起重链条直径 Chain diameter	5	5	6	6	7.1	
收缩长 Contraction distance mm	300	350	350	650	750	
主要尺寸 Dimensions(mm)	A	148	172	172	200	200
	B	90	98	98	115	115
	C	136	160	160	180	235
	D	40	44	46	50	64
	H	320	380	380	480	600
	L	280	410	410	410	410
	K	27	34	36	38	48
伸缩长 Stretch distance mm	1800	1850	1850	2150	2250	
净重 Net weight kg	4.7	5.7	9.8	19	24	
起重高度每增加1米增加重量 (kg) Extra weight per meter of extra lift	0.55	1.1	1.5	3	3.6	

HBSQ-C型防爆手拉葫芦

HBSQ-C type explosion proof chain hoist

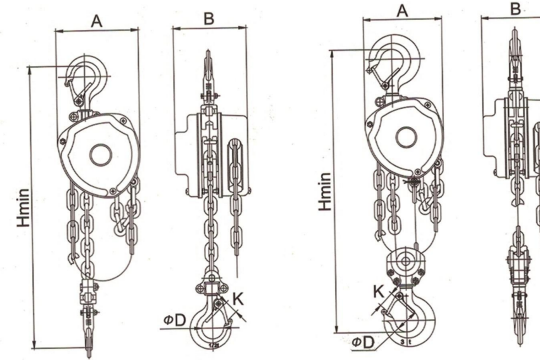

型号 Model	HBSQ-C0.5	HBSQ-C1	HBSQ-C2	HBSQ-C3	HBSQ-C5	HBSQ-C10	HBSQ-C20
额定载荷 Capacity(t)	0.5	1	2	3	5	10	20
起重高度 Lifting height(m)	2.5	2.5	2.5	3	3	3	3
试验载荷 Test load(t)	0.75	1.5	3	4.5	7.5	12.5	25
链条行数 No. of load chain fall lines	2	2	2	2	2	4	8
尺寸 Dimension(mm)	A	150	150	180	225	231	355
	B	135	135	150	175	175	175
	Hmin	280	454	496	626	640	710
净重 Net weight(kg)	13	16	26	36	40	86	185

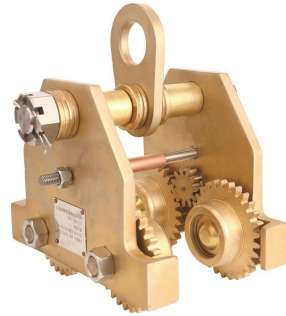

GCBL型防爆手拉小车

GCBL type explosion-proof Geared chain trolley

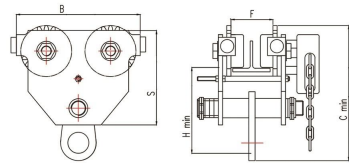

GCBT型防爆手推小车

GCBT type explosion-proof Push monorail trolley

规格 Model	GCBL1	GCBL2	GCBL3	GCBL5	GCBL10	GCBL20	
	GCBT1	GCBT2	GCBT3	GCBT5	GCBT10	GCBT20	
额定载荷 Capacity(t)	1	2	3	5	10	20	
实验载荷 Test load kN	1.5	3	4.5	7.5	15	30	
标准运行高度 Standard lifting height(m)	3	3	3	3	3	3	
满载时的手拉力(水平直道上) Hand pull(horizontal straight)N	50	90	95	140	240	250	
主要尺寸 Dimension(mm)	B	245	245	275	350	380	420
	S	170	190	220	240	265	265
	Hmin	170	190	200	210	230	320
	C	260	290	320	360	410	510
轨道宽度范围 Track width(mm)	F	90-122	102-152	110-165	122-172	130-210	130-210
净重(千克) Net weight(kg)	GCBL	15	20	26	34	51	115
	GCBT	13	17	23	30	47	106



HBSQ-Z型防爆手拉葫芦(组合式)

HBSQ-Z type explosion-proof chain hoist(combined)

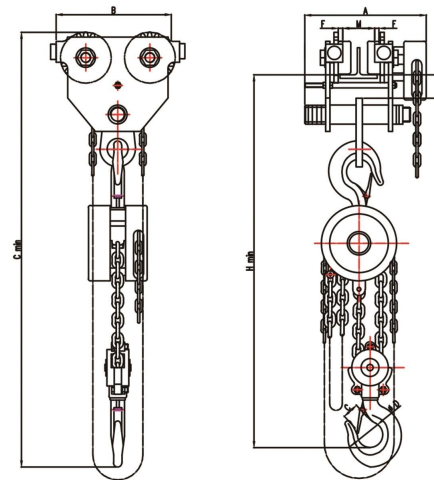

型号 Model	HBSQ-Z 0.5	HBSQ-Z 1	HBSQ-Z 2	HBSQ-Z 3	HBSQ-Z 5	HBSQ-Z 7.5	HBSQ-Z 10	HBSQ-Z 20	
额定载荷 Capacity(t)	0.5	1	2	3	5	7.5	10	20	
起重高度 Lifting height(m)	2.5	2.5	2.5	2.5	2.5	2.5	2.5	2.5	
试验载荷 Test load(t)	0.75	1.5	3	4.5	7.5	11.2	12.5	25	
链条行数 No. of load chain fall lines	1	1	2	2	2	3	4	8	
尺寸 Dimension(mm)	F	90-120	90-120	102-152	110-165	122-172	130-210	130-210	130-210
	B	245	245	275	350	380	420	420	760
	Hmin	470	496	630	800	860	1110	1130	1320
	D	30	43	50	63	65	72	77	106
净重 Net weight(kg)	27	28	36	52	72	117	134	295	



### HYBDB型防爆环链电动葫芦(固定式)

HYBDB type explosion-proof electric chain hoist(stationary type)

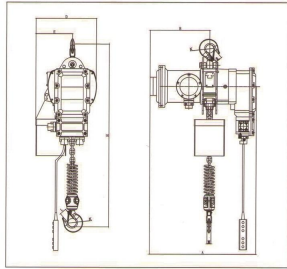

### 技术参数

型号 Type	额定荷载 Capacity (Ton)	起升速度 Lifting Speed (m/min)	起升电机 Lifting					运行电机 Operating motor						工字钢 I-Beam (mm)	
			链条行数 (No. of load chain mm)	功率 Power (kw)	转速 Rotation Speed (r/min)	相数 Phases	电压 Voltage (v)	赫兹 Frequency (Hz/s)	功率 Power (kw)	转速 Rotation Speed (r/min)	运行速度 Operating speed (m/min)	相数 Phases	电压 Voltage (v)		赫兹 Frequency (Hz/s)
HYDB1-3	1	6.8	1	1.5	1440	3	220-440	50/60	/	/	/	/	/	/	/
HYDB2-3	2	6.8	1	3	1440	3	220-440	50/60	/	/	/	/	/	/	/
HYDB2-3	2	3.4	2	1.5	1440	3	220-440	50/60	/	/	/	/	/	/	/
HYDB3-3	3	5.4	1	3	1440	3	220-440	50/60	/	/	/	/	/	/	/
HYDB3-3	3	3.4	2	3	1440	3	220-440	50/60	/	/	/	/	/	/	/
HYDB5-3	5	2.7	2	3	1440	3	220-440	50/60	/	/	/	/	/	/	/
HYDB10-3	10	2.8	4	3.0*2	1440	3	220-440	50/60	/	/	/	/	/	/	/
HYDB15-3	15	1.9	6	3.0*2	1440	3	220-440	50/60	/	/	/	/	/	/	/
HYDB20-3	20	1.4	8	3.0*2	1440	3	220-440	50/60	/	/	/	/	/	/	/
HYDB25-3	25	1.1	10	3.0*2	1440	3	220-440	50/60	/	/	/	/	/	/	/
HYDB30-3	30	0.9	12	3.0*2	1440	3	220-440	50/60	/	/	/	/	/	/	/
HYDB35-3	35	0.7	16	3.0*2	1440	3	220-440	50/60	/	/	/	/	/	/	/

### 尺寸规格

型号 Type	额定荷载 Capacity (Ton)	链条行数 (No. of load chain mm)	单位 Unit (mm)													链条直径 Chain
			H	A	B	D	E	K	L	N	M	J	Q			
HYDB1-3	1	1	600	600	330	300	176	φ40	31	24	/	/	/	/	φ7.1	
HYDB2-3	2	1	800	725	350	430	265	φ49	35	30	/	/	/	/	φ10.0	
HYDB2-3	2	2	750	600	330	300	230	φ49	35	30	/	/	/	/	φ7.1	
HYDB3-3	3	1	845	675	325	430	265	φ59	42	35	/	/	/	/	φ11.2	
HYDB3-3	3	2	950	675	325	430	320	φ59	42	35	/	/	/	/	φ10.0	
HYDB5-3	5	2	1030	675	325	430	325	φ60	45	43	/	/	/	/	φ11.2	
HYDB10-3	10	4	1400	725	350	890	445	φ90	70	50	/	/	/	/	φ11.2	
HYDB15-3	15	6	1360	725	350	1030	/	φ110	80	85	88	φ70	520	/	φ11.2	
HYDB20-3	20	8	1250	725	350	1220	/	φ110	80	85	88	φ70	/	/	φ11.2	
HYDB25-3	25	10	1700	725	350	1315	/	φ140	100	95	96	φ80	/	/	φ11.2	
HYDB30-3	30	12	1640	915	458	1380	/	φ140	100	95	228	φ90	/	/	φ11.2	
HYDB35-3	35	16	1790	915	458	1600	/	φ200	140	135	235	φ100	440	/	φ11.2	



### HYBDB型防爆环链电动葫芦(运行式)

HYBDB type explosion-proof electric chain hoist (run the type)

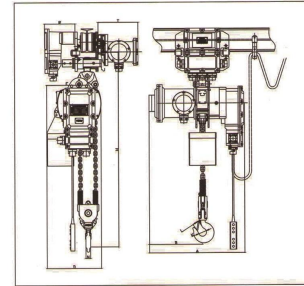

型号 Type	额定荷载 Capacity (Ton)	链条行数 (No. of load chain mm)	起升速度 Lifting Speed (m/min)	功率 Power (kw)	起升电机 Lifting					运行电机 Operating motor						工字钢 I-Beam (mm)
					转速 Rotation Speed (r/min)	相数 Phases	电压 Voltage (v)	赫兹 Frequency (Hz/s)	功率 Power (kw)	转速 Rotation Speed (r/min)	运行速度 Operating speed (m/min)	相数 Phases	电压 Voltage (v)	赫兹 Frequency (Hz/s)		
HYDB1-3	1	1	6.8	1.5	1440	3	220-440	50/60	0.8	1440	10/20	3	220-440	50/60	80-160	
HYDB2-3	2	1	6.8	3	1440	3	220-440	50/60	0.8	1440	10/20	3	220-440	50/60	82-178	
HYDB2-3	2	2	3.4	1.5	1440	3	220-440	50/60	0.8	1440	10/20	3	220-440	50/60	82-178	
HYDB3-3	3	1	5.4	3	1440	3	220-440	50/60	0.8	1440	10/20	3	220-440	50/60	100-178	
HYDB3-3	3	2	3.4	3	1440	3	220-440	50/60	0.8	1440	10/20	3	220-440	50/60	100-180	
HYDB5-3	5	2	2.7	3	1440	3	220-440	50/60	0.8	1440	10/20	3	220-440	50/60	110-180	
HYDB10-3	10	4	2.8	3.0*2	1440	3	220-440	50/60	0.8*2	1440	10/20	3	220-440	50/60	150-220	
HYDB15-3	15	6	1.9	3.0*2	1440	3	220-440	50/60	0.8*2	1440	10/20	3	220-440	50/60	150-220	
HYDB20-3	20	8	1.4	3.0*2	1440	3	220-440	50/60	0.8*2	1440	10/20	3	220-440	50/60	150-220	
HYDB25-3	25	10	1.1	3.0*2	1440	3	220-440	50/60	0.8*2	1440	10/20	3	220-440	50/60	150-220	
HYDB30-3	30	12	0.9	3.0*2	1440	3	220-440	50/60	0.8*2	1440	10/20	3	220-440	50/60	150-220	
HYDB35-3	35	16	0.7	3.0*2	1440	3	220-440	50/60	0.8*2	1440	10/20	3	220-440	50/60	150-220	

型号 Type	额定荷载 Capacity (Ton)	链条行数 (No. of load chain mm)	单位 Unit (mm)													链条直径 Chain
			H	A	B	D	E	K	L	N	J	R	T	Q		
HYDB1-3	1	1	650	600	330	300	176	φ40	31	24	φ31	224	298	/	φ7.1	
HYDB2-3	2	1	770	725	350	430	265	φ49	35	30	φ36	224	298	/	φ7.1	
HYDB2-3	2	2	740	600	330	300	230	φ49	35	30	φ36	224	298	/	φ7.1	
HYDB3-3	3	1	840	725	350	470	265	φ59	42	35	φ43	224	298	/	φ11.2	
HYDB3-3	3	2	920	725	350	430	320	φ59	42	35	φ43	224	298	/	φ10.0	
HYDB3-3	3	3	920	600	330	350	280	φ59	42	35	φ43	224	298	/	φ11.2	
HYDB5-3	5	2	1015	725	350	430	325	φ60	45	43	φ54	224	298	/	φ11.2	
HYDB7.5-3	7.5	3	1200	725	350	500	380	φ90	70	50	φ70	224	298	/	φ11.2	
HYDB10-3	10	4	1200	725	350	890	445	φ90	70	50	φ54	224	298	430	φ11.2	
HYDB15-3	15	6	1360	725	350	1030	/	φ110	80	85	φ70	224	298	520	φ11.2	
HYDB20-3	20	8	1300	725	350	1220	/	φ110	80	85	φ70	224	298	520	φ11.2	
HYDB25-3	25	10	1500	725	350	1450	/	φ140	100	95	φ75	224	298	680	φ11.2	
HYDB30-3	30	12	1640	915	458	1380	/	φ140	100	95	φ80	/	/	400	φ11.2	
HYDB35-3	35	16	1790	915	458	1600	/	φ200	140	135	φ100	/	/	440	φ11.2	







DHBS型防爆环链电动葫芦(固定式)

DHBS type explosion-proof electric chain hoist(stationary type)

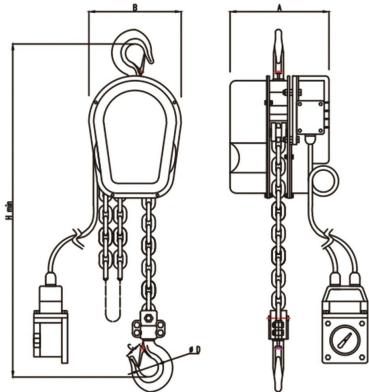

额定起重量 Rated Lifting Load	1000kg	2000kg	3000kg	5000kg	7500kg	10000kg
起升速度 Lifting Speed	2.25m/min	1.85m/min	1.1m/min	0.9m/min	0.6m/min	0.45m/min
起重高度 Lifting height(m)	3-6m	3-6m	3-6m	3-6m	3-6m	3-6m
电机型号 Motor Model	HBEY-0.8	HBEY-0.8	HBEY-0.8	HBEY-0.8	HBEY-0.8	HBEY-0.8
电机功率 Motor Power	800W	800W	800W	800W	800W	800W
电机转速 Motor Speed	1380r/min	1380r/min	1380r/min	1380r/min	1380r/min	1380r/min
电源电压 Supply Voltage	380V	380V	380V	380V	380V	380V
尺寸 Dimension(mm)	A	280	280	280	280	280
	B	275	275	275	275	340
	Hmin	520	600	680	710	850
	C	580	630	780	820	970
	D	43	50	63	65	72
整机重量 Weight	3m 40kg	43kg	50kg	70kg	72kg	107kg



DHBS型防爆环链电动葫芦(运行式)

DHBS type explosion-proof electric chain hoist(run the type)

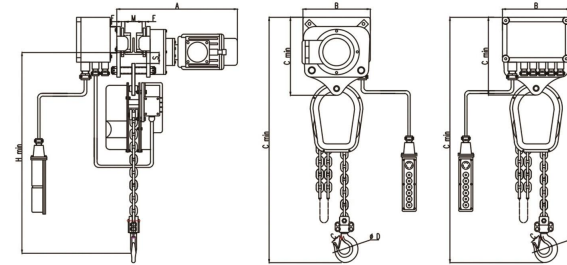

额定起重量 Rated Lifting Load	1000kg	2000kg	3000kg	5000kg	7500kg	10000kg
起升速度 Lifting Speed	2.25m/min	1.85m/min	1.1m/min	0.9m/min	0.6m/min	0.45m/min
运行速度 Running speed	20	20	20	20	10	10
起重高度 Lifting height	3-6m	3-6m	3-6m	3-6m	3-6m	3-6m
运行电机型号 Operation model of motor	BZDY0.4KW	BZDY0.4KW	BZDY0.4KW	BZDY0.8KW	BZDY0.8KW	BZDY0.8KW
电机型号 Motor Model	HBEY	HBEY	HBEY	HBEY	HBEY	HBEY
电机功率 Motor Power	800W	800W	800W	800W	800W	800W
电机转速 Motor Speed	1380r/min	1380r/min	1380r/min	1380r/min	1380r/min	1380r/min
电源电压 Supply Voltage	380V	380V	380V	380V	380V	380V
尺寸 Dimension(mm)	M	90-122	102-152	110-165	122-172	130-210
	B	350	350	360	400	450
	Hmin	610	640	790	830	1050
	C	580	630	780	820	970
	D	43	50	63	65	72
整机重量 Weight	3m 94kg	98kg	110kg	150kg	184kg	214kg

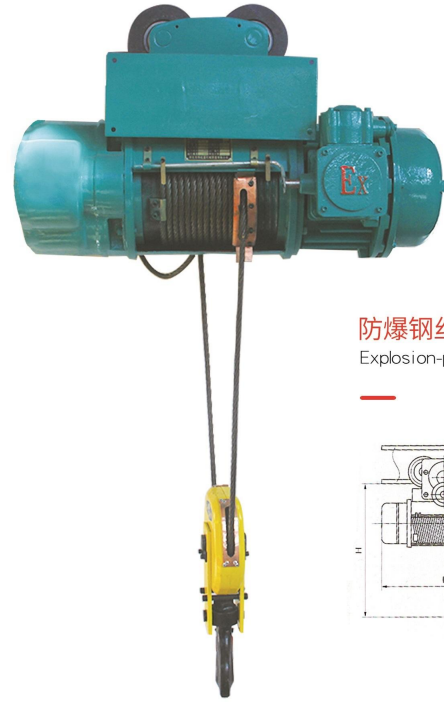

防爆钢丝绳电动葫芦

Explosion-proof wire rope electric hoist

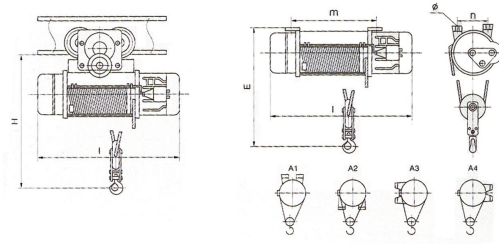

型号 Model	HB 0.5T	HB 1T	HB 2T	HB 3T	HB 5T	HB 10T
起重量 Capacity	t 0.5	1	2	3	5	10
起升高度 Lifting height	m 6 9 12 18	6 9 12 18 24 30	6 9 12 18 24 30	6 9 12 18 24 30	6 9 12 18 24 30	6 9 12 18 24 30
起升速度 Lifting speed	m/min 8	8	8	8	8	7
运行速度 Running speed	m/min 30	20	20	20	20	12
工字钢规格 (GB106-88)	16-25#	16-25#	20#-32#	20#-32#	25#-63#	25#-6#
运行轨道 Orbit						
最小曲率半径 minimum profile curvature radius	m 1.8	2	2	2.5 3	2	2.5 3 4
2.5 3 4	2	2.5 3	4	2	2.5 3 4	2.5 3 3.5 4.5 6 7.2
主电机功率 motor power	kw 0.8	1.5	3	4.5	7.5	13
运行电机功率 Run the motor power	kw 0.2	0.2	0.4	0.4	0.8	0.5
基本尺寸 Basic L dimensions	mm 770 846 920 1066 820 915 1015 1210 1400 1600 875 975 1275 1475 1675 990 1085 1200 1400 1600 1820 1110 1215 1320 1530 1740 1950 1500 1700 1880 2230 2600 2980					
f	mm 690 690 719 927 810		866 966	961 1060	1177 1327	1360 1100
Bmax	mm 927		965 1100			
总重 Total weight	kg 145 156 165 185 155 170 185 215 245 275 310 330 350 390 430 470 350 380 410 470 500 530 580 610 630 690 730 780 1100 1160 1240 1350 1480 1660					



HB-G型防爆卷扬机

HB-G type explosion-proof electric hoist

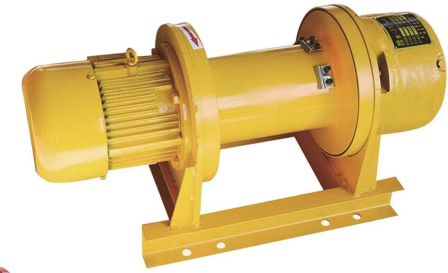

HB-T型防爆电动提升机

HB-T type explosion-proof electric hoist



起重量 Lifting weight	吨t	0.5	1	2	3	5	10
起升高度 Lifting height	米m	150	150	150	150	150	150
起升速度 Lifting speed	米/分	8/16	8/16	8/16	8/16	8/16	8/16
钢丝绳 a wire rope	绳直径 rope diameter	毫米mm 4.8	7.4	11	13	15.5	15.5
丝直径 wire diameter	毫米mm 0.22	0.22	0.5	0.6	0.7	0.7	
结构形式 structural style		D-6X37+1	D-6X37+1	D-6X37+1	D-6X37+1	D-6X37+1	D-6X37+1
电机型号 Motor type		BZD21-4 0.8KW	BZD22-4 1.5KW	BZD31-4 3.0KW	BZD32-4 4.5KW	BZD41-4 7.5KW	BZD51-4 13KW
功率 power	千瓦	0.8	1.5	3	4.5	7.5	13
转速 speed	转/分	1380	1380	1380	1380	1400	1400
相数 Phase number		3	3	3	3	3	3
起升电动机 Lifting motor	电压 Voltage	伏 380	380	380	380	380	380
电流 electric current	安培	2.4	4.3	7.6	11	18	30
频率 Frequency	Hz	50	50	50	50	50	50

型号 Model	1T	2T	3T	5T
使用方法	单绳 双绳	单绳 双绳	单绳 双绳	单绳 双绳
额定电压 (v)	380	380	380	380
功率 (KW)	1.5	3	4.5	7.5
额定起重 (kg)	500 1000	1000 2000	1500 3000	2500 5000
起升速度 (m/min)	16.0 8.0	16 8	16 8	16 8
起升高度 (m)	30-100	30-100	30-100	30-100
绳直 (mm)	8	11	13	15
净重 (kg)	80	130	160	260
钢丝绳 (寸)	7.7#	11#	13#	15#
整机长度 (mm)	770	830	930	1080
槽钢长度 (mm)	530	600	650	750
高度 (mm)	410	520	540	600
宽度 (mm)	310	430	450	510
中心距 (mm)	260	260	290	310